



box USER GUIDE – SECURELY UPLOADING FILES TO CITADEL SERVICING CORPORATION

You can view our [Privacy Policy here](#). To upload files to Citadel Servicing Corporation, you will be sent an email invitation from **noreply@box.com** with a link to a secure upload folder.

#1 - Accept the Invitation

Open the email invitation from **noreply@box.com** and select the **Go to Folder** button. This will take you to the Box website.

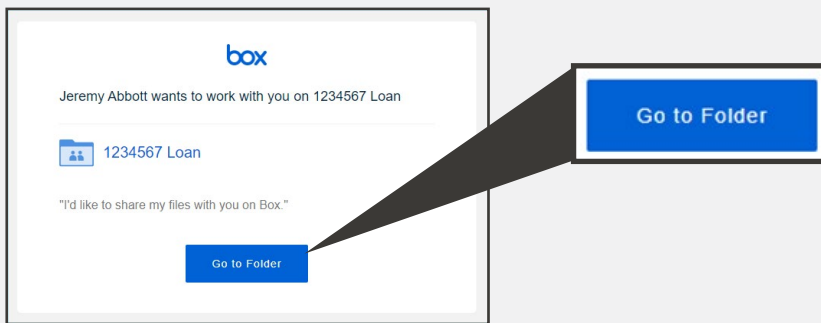

#2 - Create a Box Password

Enter your **full name**, then create a **password** for your new Box login.

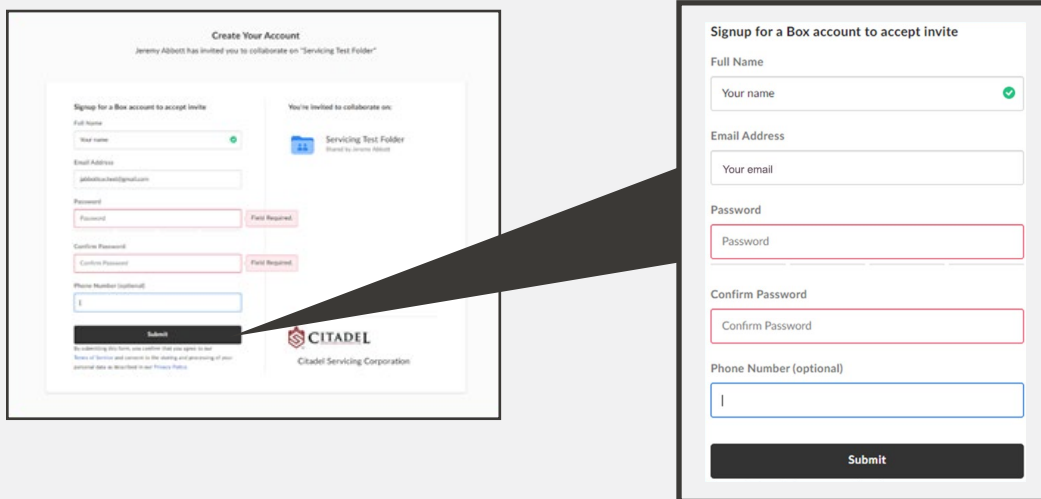

CITADEL SERVICING CORPORATION ("CSC") IS A COLLECTOR ATTEMPTING TO COLLECT A DEBT; ANY INFORMATION OBTAINED WILL BE USED FOR THAT PURPOSE. IF YOU OR YOUR ACCOUNT ARE SUBJECT TO PENDING BANKRUPTCY OR THE OBLIGATION REFERENCED IN THIS STATEMENT HAS BEEN DISCHARGED IN A BANKRUPTCY PROCEEDING, THIS STATEMENT IS FOR INFORMATIONAL PURPOSES ONLY AND IS NOT AN ATTEMPT TO COLLECT A DEBT. PLEASE CALL "CSC" IF YOU HAVE ANY QUESTIONS ABOUT THIS STATEMENT AT 1-888-800-7661. *Rates, terms, and programs are subject to change without notice. This is not a commitment to make a loan or approval of particular loan terms. Offer of credit subject to credit approval per applicable underwriting and program guidelines, applicant eligibility and market conditions. Not all applicants may qualify. Citadel Servicing Corporation is an equal opportunity lender. Not valid in the following states: AK, HI, IO, MA, MS, MO, NM, NY, ND, OH, RI, SD, and WV. Citadel Servicing Corporation NMLS ID# 144549, Licensed under Division of Business Oversight Under the California Residential Mortgage Lending Act license # 41DBO-74196; Finance Lenders License # 60DB094450; and CA-DRE # 01799059.

#3 - Upload Your Files

Once inside the loan file, you can easily upload files to Box using the drag and drop feature or using the upload button, shown below.

Option 1: Upload from the File Browser

Click the **Upload** button on the top right of the screen, then select the files from your PC.

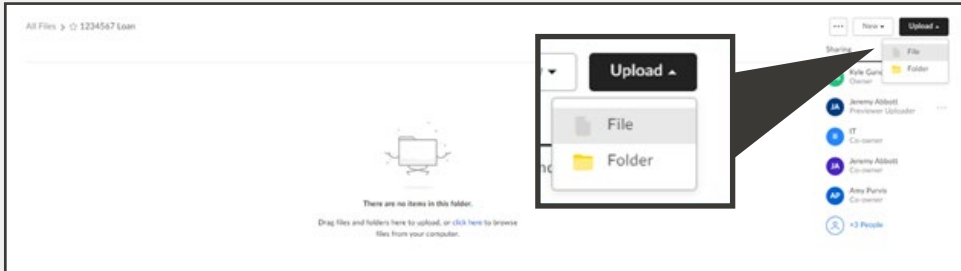

Option 2: Drag and Drop

Open the file folder location in a separate window, drag and drop the contents into Box through your browser.

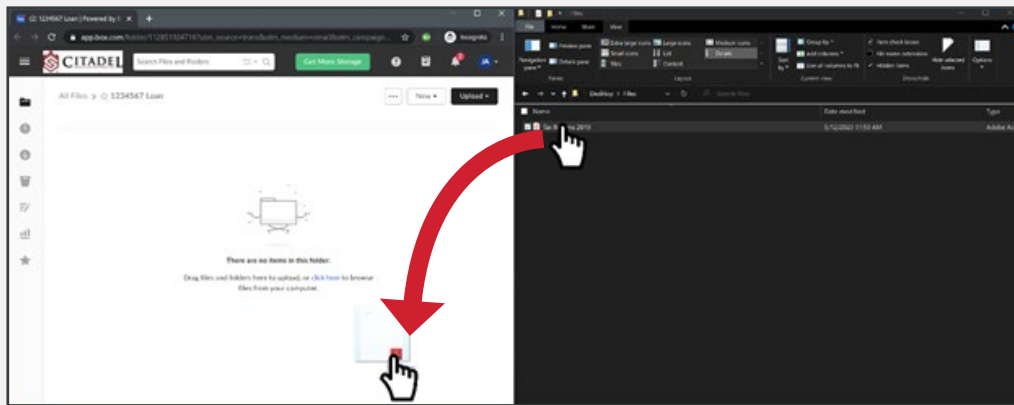

#4 - Wait for upload confirmation

Once your file has been uploaded, you will receive a confirmation in your browser.

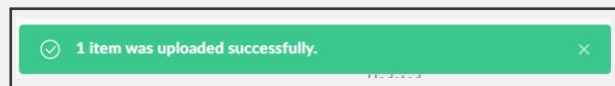
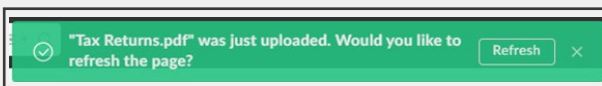

CITADEL SERVICING CORPORATION ("CSC") IS A COLLECTOR ATTEMPTING TO COLLECT A DEBT; ANY INFORMATION OBTAINED WILL BE USED FOR THAT PURPOSE. IF YOU OR YOUR ACCOUNT ARE SUBJECT TO PENDING BANKRUPTCY OR THE OBLIGATION REFERENCED IN THIS STATEMENT HAS BEEN DISCHARGED IN A BANKRUPTCY PROCEEDING, THIS STATEMENT IS FOR INFORMATIONAL PURPOSES ONLY AND IS NOT AN ATTEMPT TO COLLECT A DEBT. PLEASE CALL "CSC" IF YOU HAVE ANY QUESTIONS ABOUT THIS STATEMENT AT 1-888-800-7661. *Rates, terms, and programs are subject to change without notice. This is not a commitment to make a loan or approval of particular loan terms. Offer of credit subject to credit approval per applicable underwriting and program guidelines, applicant eligibility and market conditions. Not all applicants may qualify. Citadel Servicing Corporation is an equal opportunity lender. Not valid in the following states: AK, HI, IO, MA, MS, MO, NM, NY, ND, OH, RI, SD, and WV. Citadel Servicing Corporation NMLS ID# 144549, Licensed under Division of Business Oversight Under the California Residential Mortgage Lending Act license # 41DBO-74196; Finance Lenders License # 60DB094450; and CA-DRE # 01799059.